

REAR VIEW

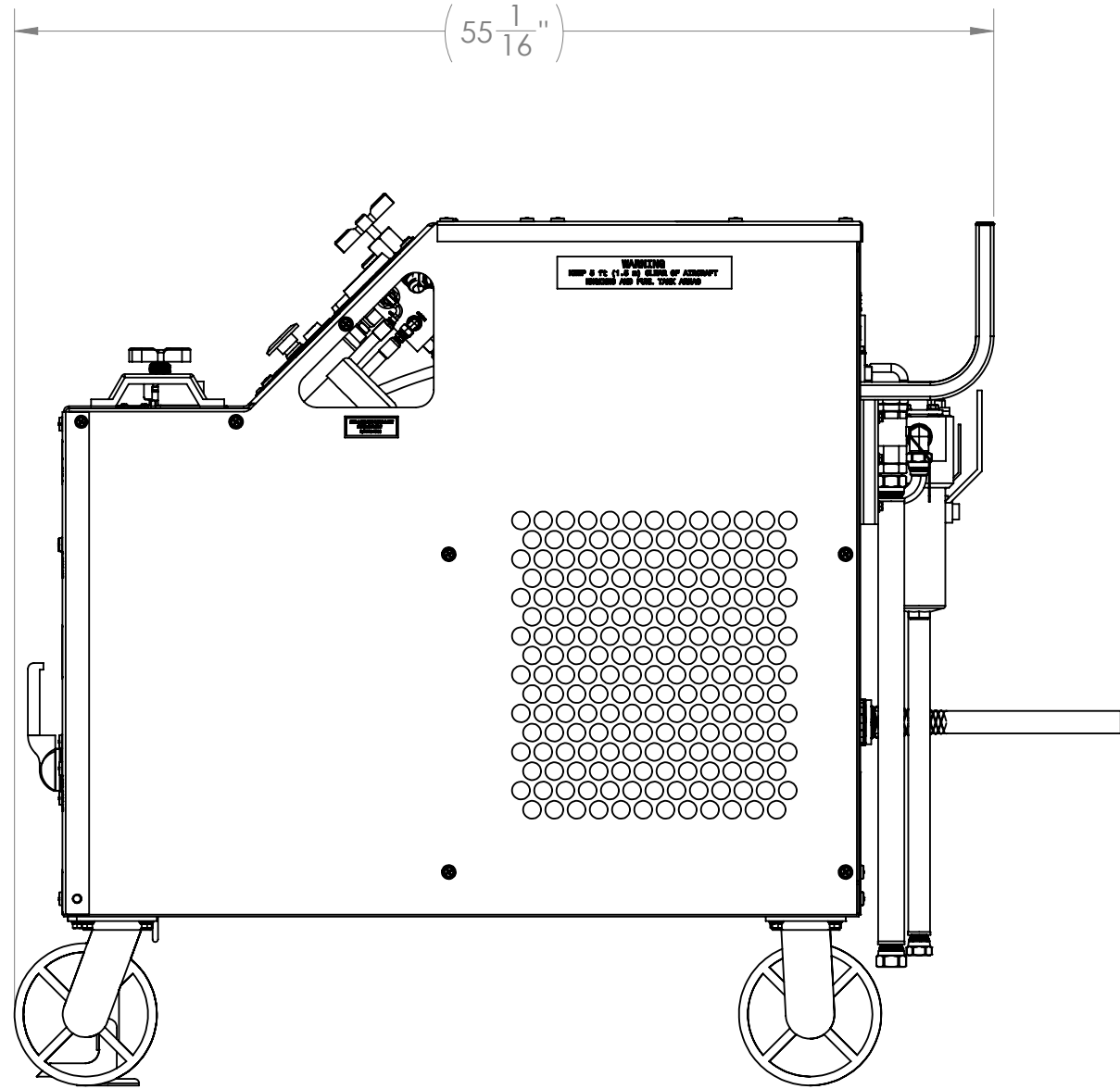
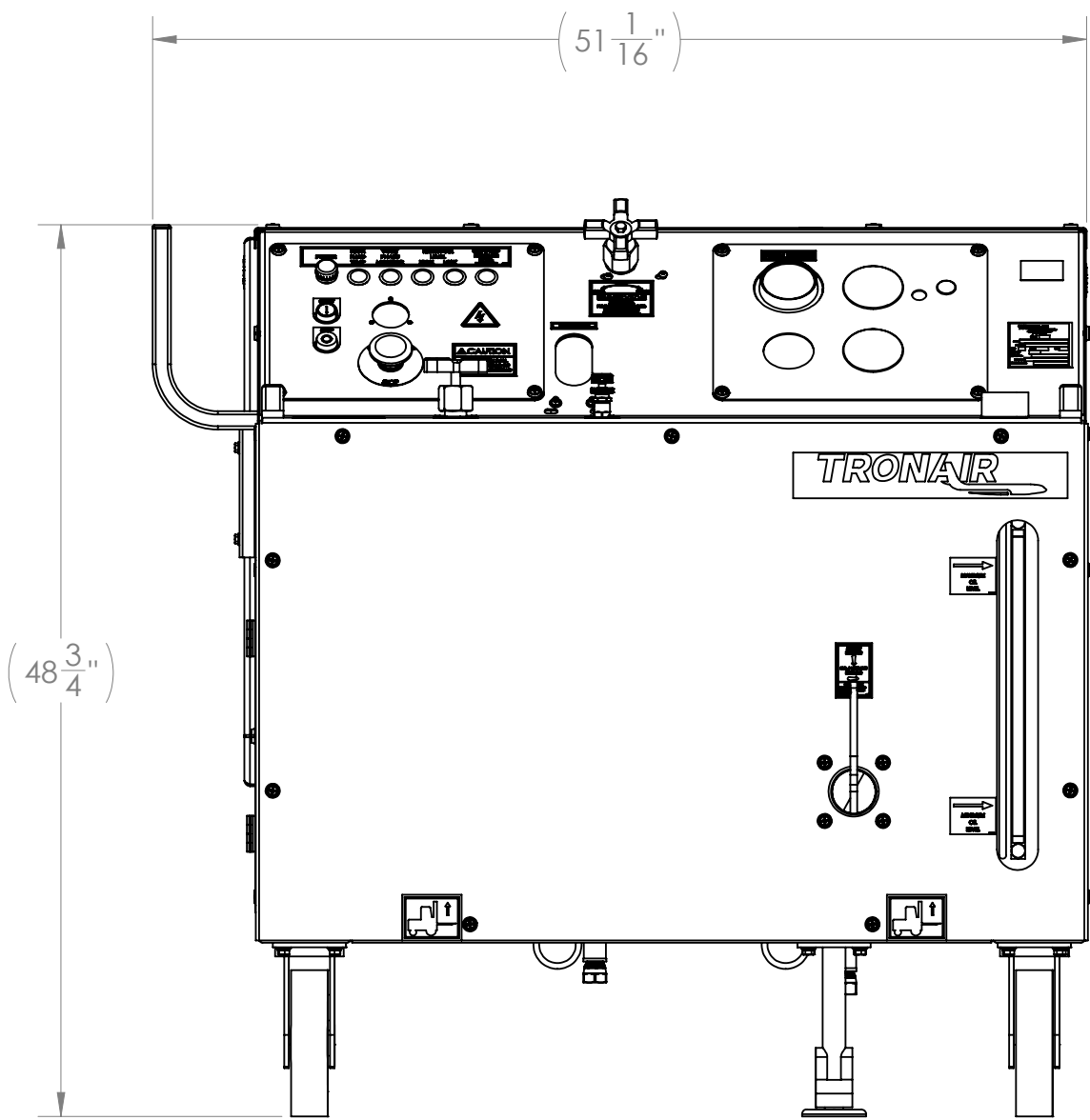
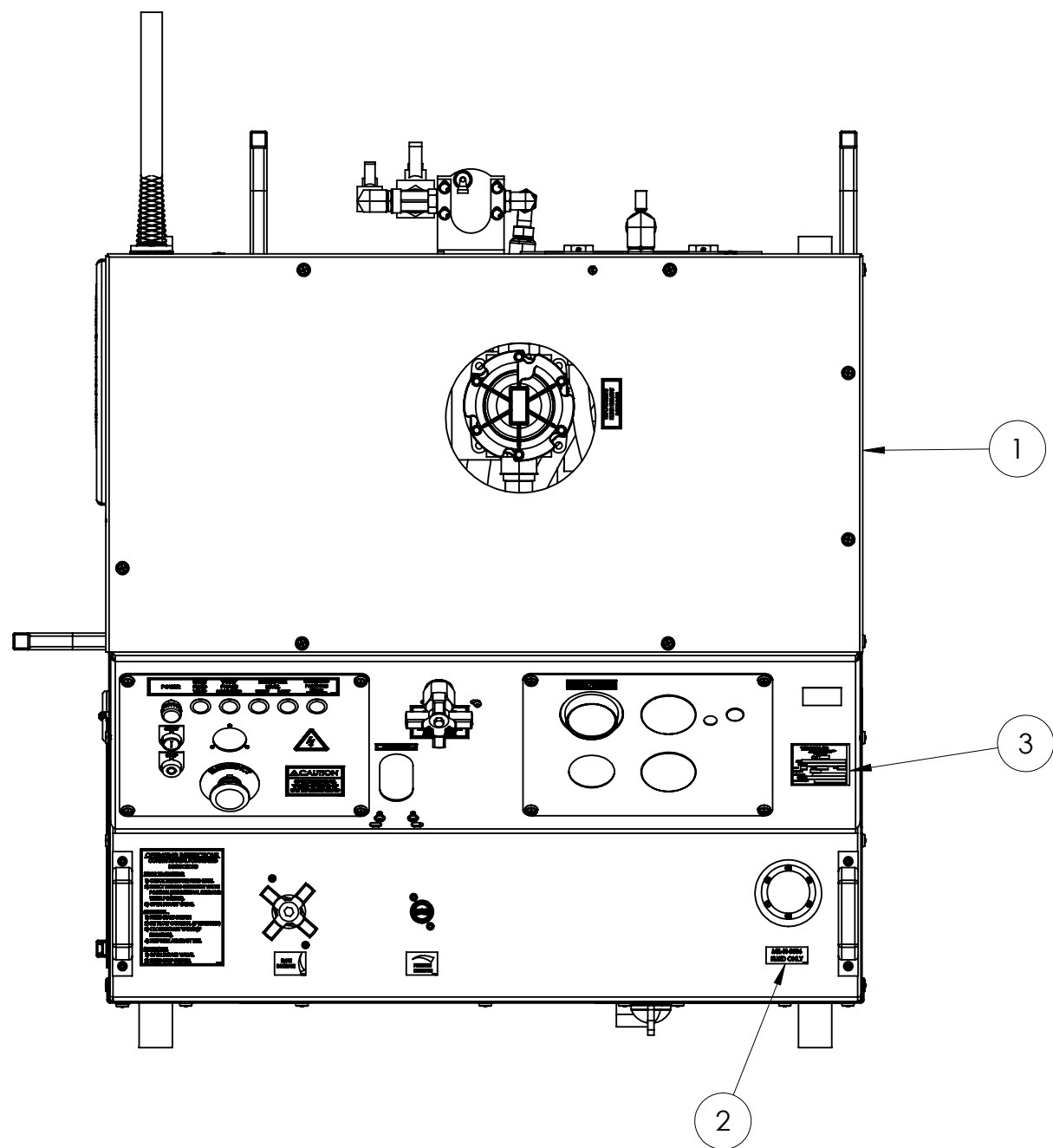
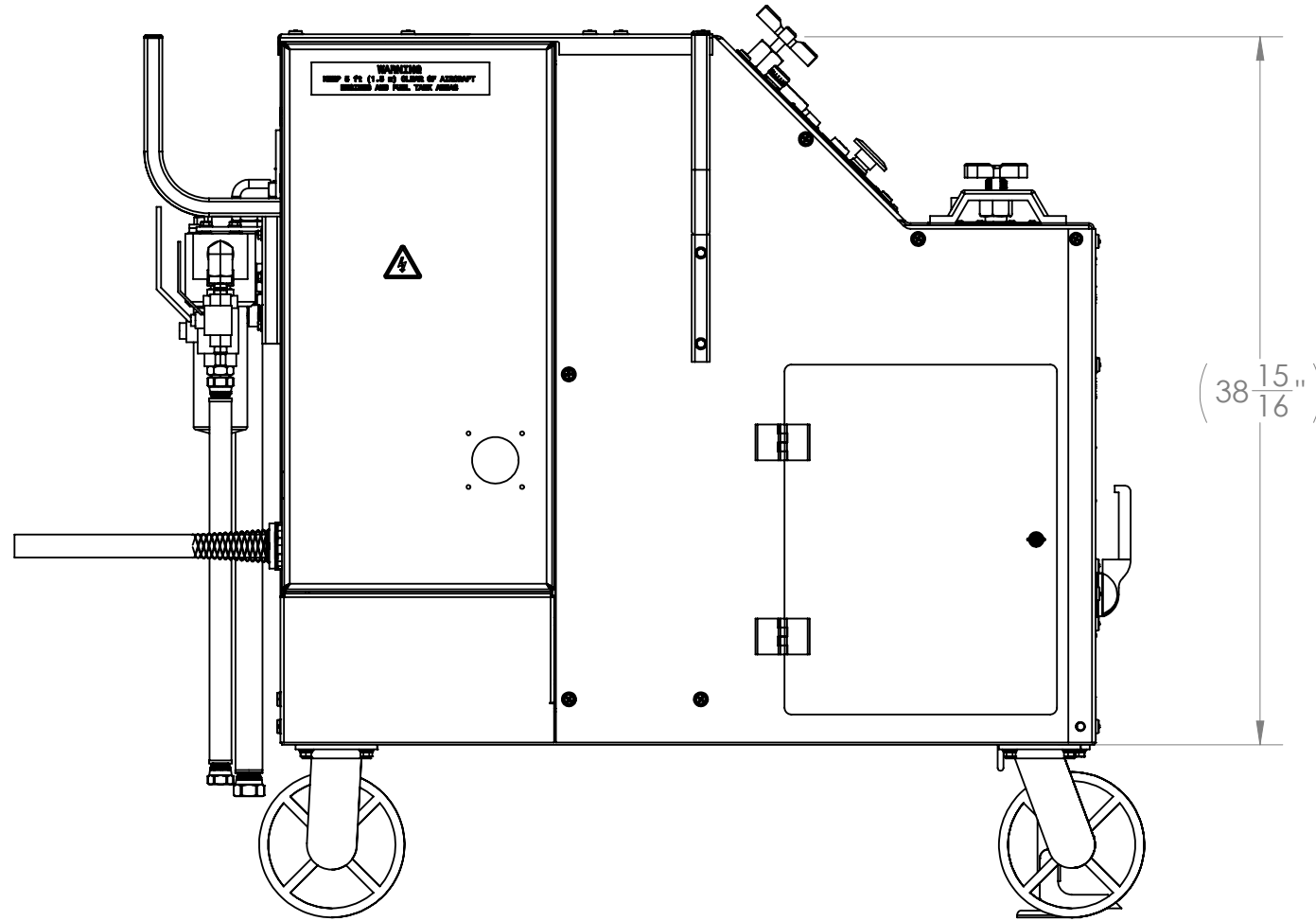

REVISIONS					
REV	DESCRIPTION	EC#	DWN	CHK	DATE
F	CONFIGURATION CHANGE	12987	GAM	PEH	04-19-03
G	ADDED 5441 SERIES	13573	WCG	PEH	1-26-04
H	1: WAS QTY 1 2: WAS QTY 1	13330	WCG	WCG	3-15-04
J	WAS QTY 6.00	18903	JMB	WCG	08-06-13
K	ADDED EC-1755	22305	ADO	PEH	12-07-20
L	ADDED HC-1951-16, HC-1951-20 & HC-1951-24	22305	ADO	PEH	10-22-21
M	UPDTAED FOR LOAD SENSE 1 WAS INS-1602 2 WAS INS-1612 3 WAS Z-5786	24923	JMW	PEH	01-18-2023

GENERAL DESCRIPTION:

OVERALL HEIGHT: 50 1/4"
OVERALL WIDTH: 51 1/16"
OVERALL LENGTH: 55 1/16"
WEIGHT: 1450LB

FLUID: MIL-PRF-5606
MIL-PRF-83282
AVIATION PHOSPHATE ESTER
MIL-PRF-87257

FINISH: P-1001-10
MAX PRESSURE: 3500 PSIG
MAX FLOW: 15 GPM
MOTOR POWER: 25 HP

INSTRUCTIONS:

- TEST PER INS-2752
- LUBRICATE CASTERS WITH MULTI PURPOSE GREASE
- UNIT SHIPPED WITHOUT OIL IN RESERVOIR

NOTES:

- MOTOR IS PRE-GREASED AT LINCOLN FACTORY. NO GREASING REQUIRED BY TRONAIR
- ALL BOLTS ARE GRADE 5 OR BETTER
- OPTIONS AVAILABLE:

- | | | | |
|---|-----------------------------|---|--------------------------------|
| B | 50 FT HOSES | J | VOLTAGE MONITOR (575V) |
| C | SPLIT SYSTEM | K | PYROMETER |
| D | SPLIT SYSTEM W/X-OVER CHECK | L | ELECTRIC RESERVOIR LEVEL |
| E | HOURLMETER (50 HZ) | M | HAND PUMP |
| F | HOURLMETER (60 HZ) | N | TRAILER PACKAGE |
| G | VOLTAGE MONITOR (200-230V) | Q | CALIBRAQION PORT |
| H | VOLTAGE MONITOR (380V) | R | ELECT. FLTR CLOGGING INDICATOR |
| I | VOLTAGE MONITOR (415-460V) | S | ELECTRIC OVERTEMPERATURE |
| | | U | RETURN SIGHTGAUGE |
| | | V | RETURN BACKPRESSURE |
| | | 4 | DRIP PAN |

14	EC-1755	EC-1755	EC-1755	EC-1755	HARNESS, WIRING (NOT SHOWN)	1
13	C-5411	C-5421	C-5431	C-5441	CUSTOMER PARTS LIST (NOT SHOWN)	
12	INS-2620	INS-2620	INS-2620	INS-2620	SCHEMATIC, HYDRAULIC (NOT SHOWN)	1
11	INS-2752	INS-2752	INS-2752	INS-2752	INSTRUCTION, TEST (NOT SHOWN)	1
10	HC-1951-24	HC-1951-24	HC-1951-24	HC-1951-24	SEAL, CONICAL (-24)	2
9	HC-1951-20	HC-1951-20	HC-1951-20	HC-1951-20	SEAL, CONICAL (-20)	7
8	HC-1951-16	HC-1951-16	HC-1951-16	HC-1951-16	SEAL, CONICAL (-16)	8
7	TF-1038-10-300	TF-1038-10-300	TF-1040-01-300	TF-1038-10-300	ASSEMBLY, HOSE	REF
6	TF-1039-02-300	TF-1039-02-300	TF-1041-01-300	TF-1039-22-300	ASSEMBLY, HOSE #16	REF
5	N-2007-24-S-B	N-2007-24-S-B	N-2007-24-S-E	N-2007-24-S-V	CONNECTOR, STR THD	1
4	L-1003	L-1005	L-1006	L-1012	FLUID, HYDRAULIC	12
3	V-1845	V-1845	V-1845	V-1845	LABEL, SERIAL NO. CE	1
2	V-1975	V-1976	V-1977	V-2027	LABEL, MIL-H-5606	2
1	Z-11892-01	Z-11892-01	Z-11892-02	Z-11892-03	ASSEMBLY, LABEL & SHEETMETAL	1
ITEM NO.	5411 (MB)	5421 (MB)	5431 (PE)	5441 (MB)	DESCRIPTION	QTY.

MADE FROM SEE BOM	BREAK ALL SHARP EDGES AND CORNERS INTERPRET PER ASME Y14.5-2009	TRONAIR AIRCRAFT GROUND SUPPORT EQUIPMENT
MATERIAL SEE BOM	DIMENSIONS IN INCHES AND TOLERANCES PER BELOW UNLESS OTHERWISE SPECIFIED: DIMENSION INCH [mm]: X [X] ± .1 [3] .XX [X] ± .03 [0.8] .XXX [XX] ± .010 [0.25] .XXXX [XXX] ± .0030 [0.076] FRACTION INCH [mm]: 1/XX (1/X) ± 1/16 [1.6] ANGULAR DEGREE [RADIAN]: X [XXX] ± .5 [0.01]	
FRESH MILL	THIRD ANGLE PROJECTION	
SCALE: 1:10	SIZE D	
DO NOT SCALE DRAWING		UNIT, HYDRAULIC POWER (CE)
		54X1
		WEIGHT: 1450 LB
		SHEET 1 OF 1