



**Model: K-2112**

**TFE-731 Engine Stand**

**\*\*\***

**Parts List  
With Illustrations**

03/2005 – Rev. 02

**When ordering Replacement Parts/Kits, please specify Model, Color and Serial Number of your Unit.**

This product can not be modified without the written approval of Tronair, Inc. Any modifications done without written approval voids all warranties and releases Tronair, Inc., its suppliers, distributors, employees, or financial institutions from any liability from consequences that may occur. Only Tronair OEM replacement parts shall be used.

This K-2112 Kit is to be used with 08-2001-0000 engine stand.

#### **ENGINE SUPPORT INSTALLATION INSTRUCTIONS:**

1. Attach the upright post assembly to the base at base position "D" with 1/2-20 x 1 1/2" long hex head bolts, washers and elastic stopnuts, reference Figure 1 Engine Stand (assembled).

**Note: The engine stand base has five (5) locations for mounting various supports and the upright post assembly.**

2. Attach engine support to the base at base position "B" with 3/8-24 x 2" long bolts, bevel washers, flat washers and elastic stopnuts, reference Figure 1 Engine Stand (assembled).

**Note: One of the engine mounting arms is adjustable. This arm can be located on either side.**

3. Assure that all nuts and bolts are secure before placing an engine in the stand.

#### **ENGINE INSTALLATION INSTRUCTIONS:**

It is recommended that the engine mounting pads, item 7, be removed from the engine support arms, Item 9, and attached directly to the engine before the engine is lowered into the stand.

1. With the engine hung from the 08-0201-4000 engine sling, remove the existing lower airframe engine mount from the engine.
2. Attach the two (2) engine mounting pads, Item 7, onto the ENGINE SUPPORT AND HOUSING AND INTERMEDIATE CASE ASSEMBLY of the engine, one on each side, at the lower locations. Assure that the mounting pad spring loaded pins are engaged fully into the ENGINE SUPPORT HOUSING.
3. Lower the Garrett engine into the engine stand and align holes in engine mounting pads, Item 7, with the holes in the engine mounting arms, Item 9, on the support, and assemble with 1/2 - 20 x 1 3/4" long hex head bolts, washers, and elastic stopnuts..
4. Attach engine sling to the upright post assembly with 3/8-24 x 3 1/2" long hex head bolts, washers and elastic stopnuts.
5. The engine installation is now complete.
6. To remove engine, reverse the above process.

### Parts List

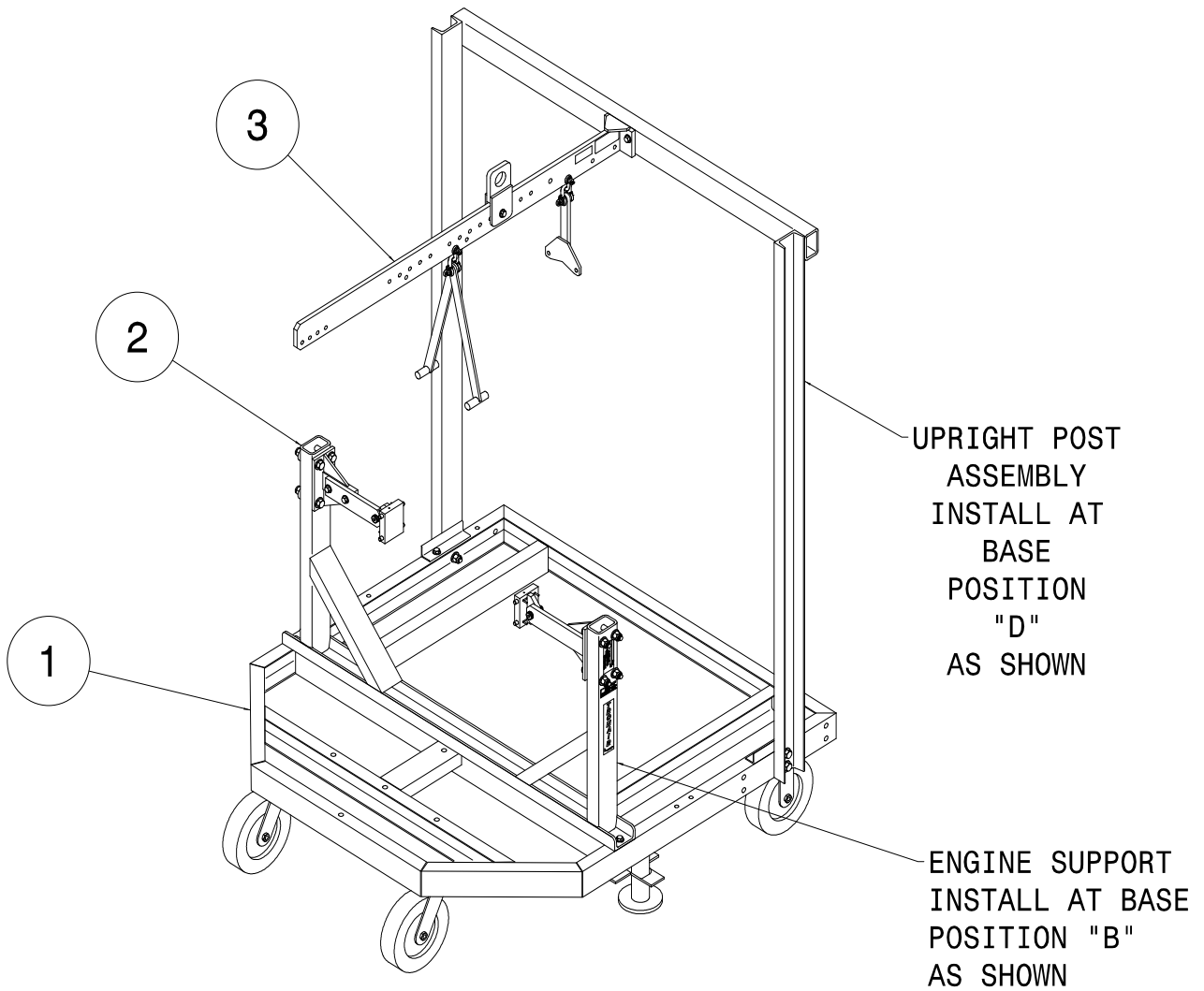

Item	Part Number	Description	Qty
1	08-2001-0000	Engine Stand	Ref
2	K-2112	Engine Support	1
3	08-0102-4000	Engine Sling	Ref

### Parts List

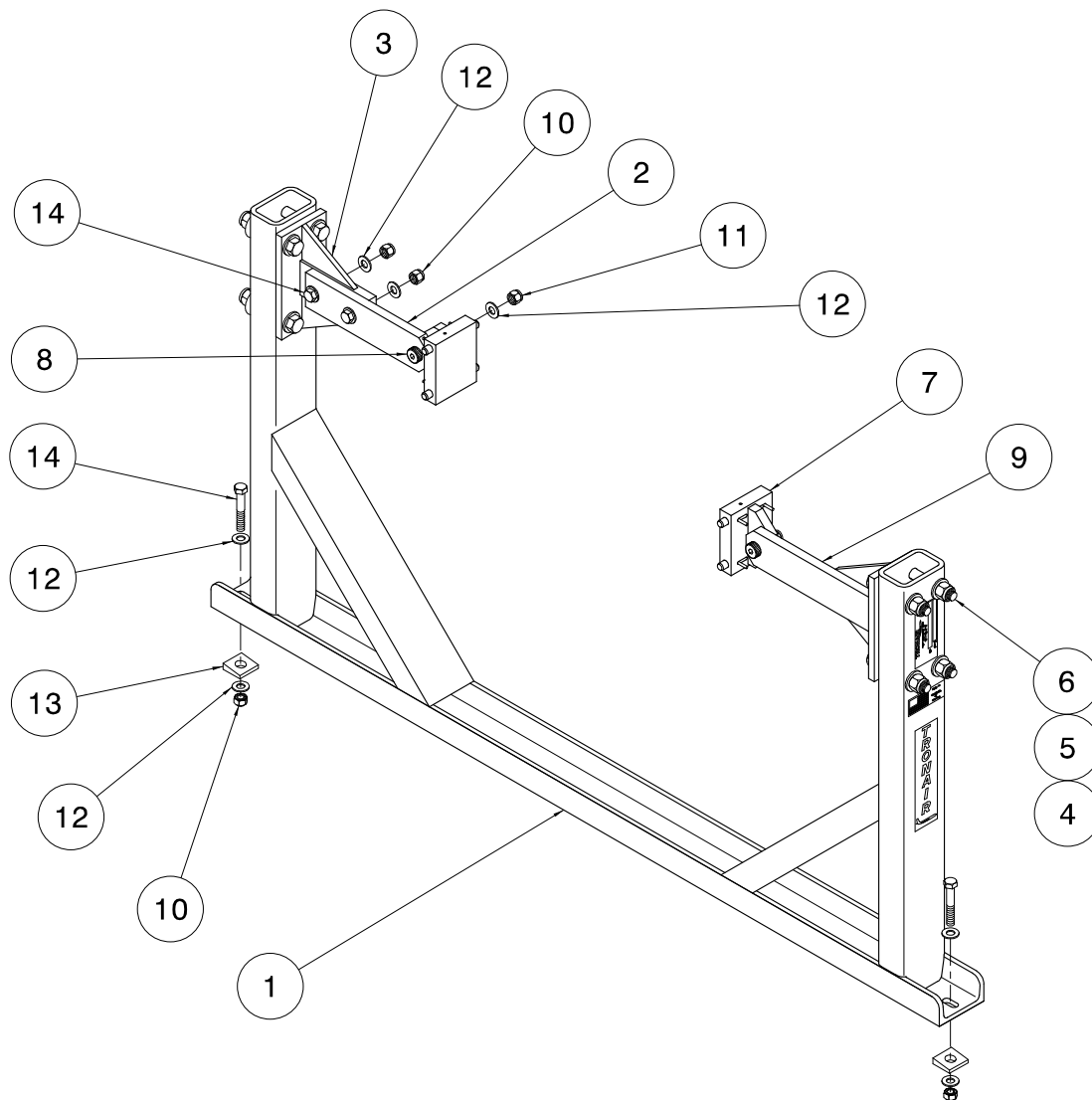

Item	Part Number	Description	Qty
1	Z-1304-01	Weldment, Support	1
2	J-1196	Adjustable Arm	1
3	Z-1302	Arm Mounting Weldment	1
4	G-1255-09	AN Washer, 1/2 "	16
5	G-1202-1095	Elastic Stopnut, 1/2 - 20	8
6	G-1420-109534	Bolt, HH, Gr 8, 1/2 - 20 x 3 1/2 " Lg	8
7	Z-1195	Mounting Pad Assembly	2
8	G-1155-107210	Scr, Soc HD Shldr 1/2 x 1 Lg 3/8 - 16 thd	2
9	Z-1303	Mounting Weldment	1
10	G-1202-1075	Elastic Stopnut, 3/8 - 24	4
11	G-1202-1070	Elastic Stopnut, 3/8 - 16	2
12	G-1250-1070N	Flatwasher, 3/8 " Narrow	10
13	G-1278	Bevel Washer, 3/8	2
15	G-1420-107516	Bolt, HH, Gr 8, 3/8 - 24 x 1 1/4 " Lg.	4