



Model: K-2114

CJ-610 Engine Support

**Parts List
With Illustrations**

03/1997 – Rev. 01

When ordering Replacement Parts/Kits, please specify Model, Color and Serial Number of your Unit.

1740 Eber Rd
Holland, OH 43528-9794
USA

Tronair, Inc.
www.tronair.com
Email: sales@tronair.com

Phone: (419) 866-6301
800-426-6301
Fax: (419) 867-0634

This product can not be modified without the written approval of Tronair, Inc. Any modifications done without written approval voids all warranties and releases Tronair, Inc., its suppliers, distributors, employees, or financial institutions from any liability from consequences that may occur.

This CJ-610 Support Kit is to be used with 08-2001-0000 engine stand base and 08-0100-4000 engine sling.

The engine stand base has five (5) locations for mounting various supports and the upright post assembly. These positions are listed as "A through E" reference figure 2 engine stand assembly locations.

ENGINE SUPPORT INSTALLATION INSTRUCTIONS:

1. Attach the upright post assembly to the base at base position "D" with 1/2-20 x 1 3/4" long hex head bolts, washers and elastic stopnuts, reference figure 2 engine stand (assembled).
2. Attach engine support to the base at center position with 3/8-24 x 1 3/4" long bolts, bevel, washers, flat washers and elastic stopnuts, reference figure 2 engine stand (assembled).
3. Assure that all nuts and bolts are secure before placing an engine in the stand.

ENGINE INSTALLATION INSTRUCTIONS:

1. With the engine hung from the 08-0100-4000 engine sling, remove the existing lower airframe engine mount from the engine.
2. Lower the engine into the engine stand and align engine stand mounts with engine mounting pads.
3. Attach engine sling to the upright post assembly with 3/8-24 x 3 1/2" long hex head bolts, washers and elastic stopnuts.
4. The engine installation is now complete.
5. To remove engine, reverse the above process.

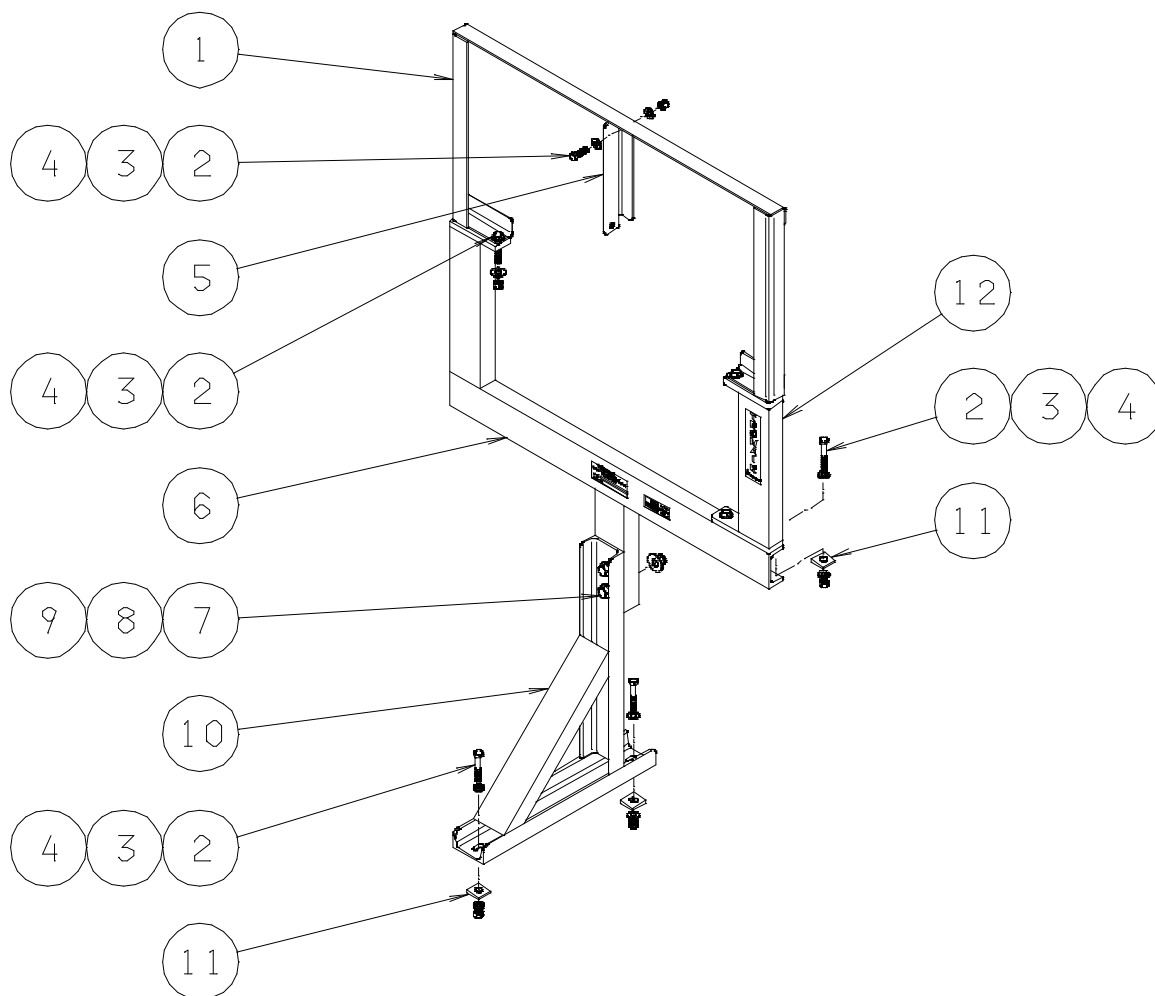
FIGURE 1

Replacement Parts

ITEM	PART NUMBER	DESCRIPTION	QTY
1.....	Z-3716-01.....	Weldment, CJ-610 Adapter.....	1
2.....	G-1420-107516.....	Bolt, 3/8-24 Hex Hd GR 8.....	7
3.....	G-1255-07.....	Washer, 3/8 AN.....	14
4.....	G-1202-1075.....	Stopnut, 3/8-24 Elastic.....	7
5.....	A-1149-01.....	Angle, Connector.....	1
6.....	Z-3714-01.....	Weldment, Engine Adapter.....	1
7.....	G-1420-109516.....	Bolt, 1/2-20 Hex Hd GR 8.....	2
8.....	G-1250-1090.....	Flatwasher, 1/2 Narrow.....	4
9.....	G-1202-1095.....	Stopnut, 1/2-20 Elastic.....	2
10.....	Z-0055-01.....	Weldment, Support.....	1
11.....	G-1258.....	Washer, 3/8 Modified Bevel.....	4
12.....	Z-3715-01.....	Weldment, Arm.....	1

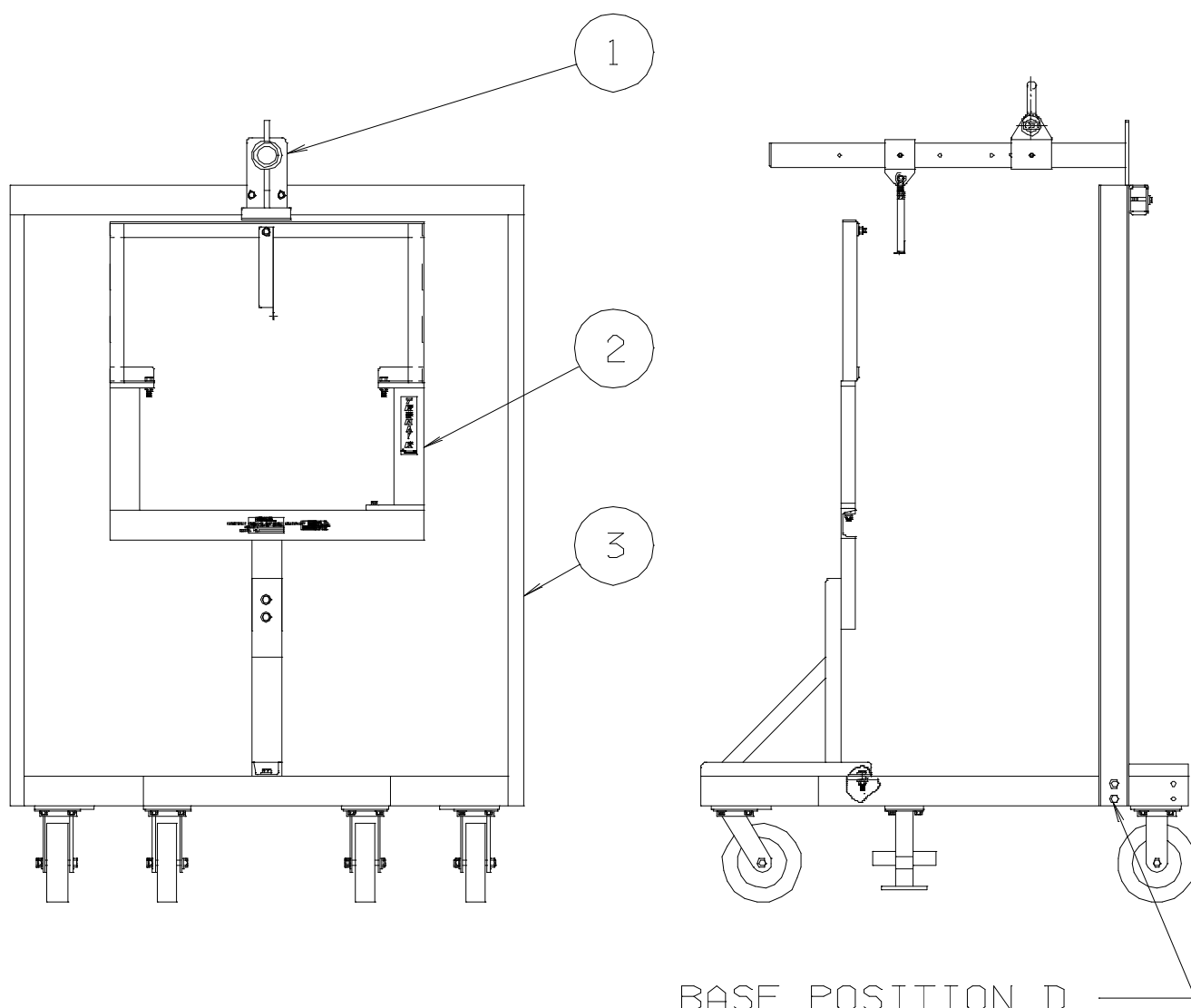
FIGURE 2



Replacement Parts

ITEM	PART NUMBER	DESCRIPTION	QTY
1	08-0100-4000	Sling	Ref.
2	K-2114	Engine Support	1
3	08-2001-0000	Engine Stand	Ref.