



**Model: K-2770  
TFE-731  
Engine Adapter Kit**

**\*\*\***

**Parts List  
With Illustrations**

07/1997 – Rev. OR

**\*\* When ordering Replacement Parts/Kits, please specify Model, Color and Serial Number of your Unit.\*\***

***Tronair, Inc.***

*1740 Eber Road  
Holland, Ohio 43528-9794  
USA*

*Telephone: (419) 866-6301 • 800-426-6301*

*Fax: (419) 867-0634*

**Web Site: [www.tronair.com](http://www.tronair.com) E-mail: [sales@tronair.com](mailto:sales@tronair.com)**

**Model: K-2770**  
**TFE-731 Engine Adapter Kit**

This product can not be modified without the written approval of Tronair, Inc. Any modifications done without written approval voids all warranties and releases Tronair, Inc., its suppliers, distributors, employees, or financial institutions from any liability from consequences that may occur. Only Tronair OEM replacement parts shall be used.

This Pratt Whitney TFE-731 engine support kit is to be used with the 08-2030-0000 engine stand. The engine stand has multiple adjustments to accommodate the installation of various engines by using specific engine adaptor kits.

**ENGINE INSTALLATION INSTRUCTIONS:**

1. With engine hung from the 08-0102-4010 engine sling, remove the existing air frame mounts from the engine.
2. Attach the engine mounting pads (Z-3790) to the engine mounting locations on the front of the engine and attach the rear mounting adaptor (Z-3801) to the rear attach point on the engine. (See figure 1)
3. Position the front support beam 21 3/4 inches from the rear support post. (See Figure 1)
4. Position the height of the rear support up 12 13/16 inches. (See Figure 1)
5. Position engine into the engine stand and attach rear adapter to engine stand.
6. Adjust final location of the front support beam and attach the front engine mounting pads to the engine stand.
7. Tighten the lock out screws on the front support beam.
8. The engine sling can now be removed for engine service.
9. Reverse steps 2-8 to remove the engine from the stand.

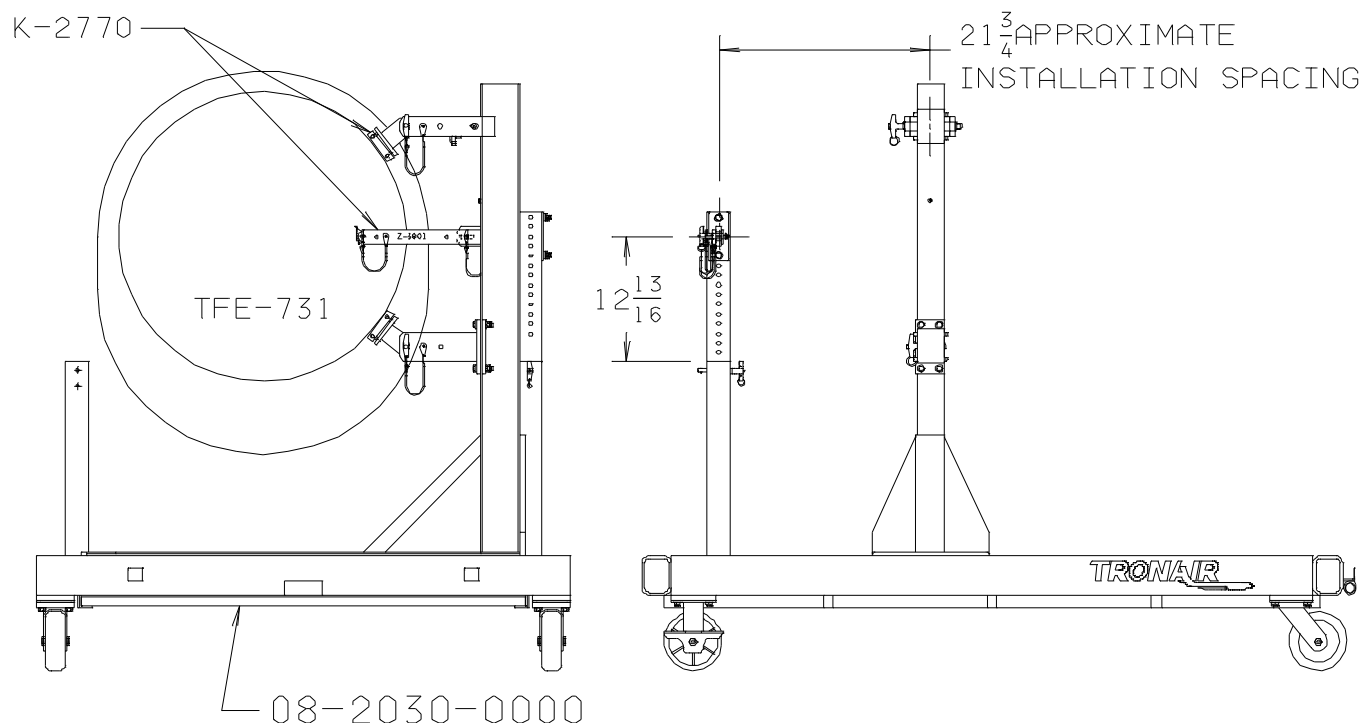

**FIGURE 2**

Model: K-2770  
TFE-731 Engine Adapter Kit

## Parts List

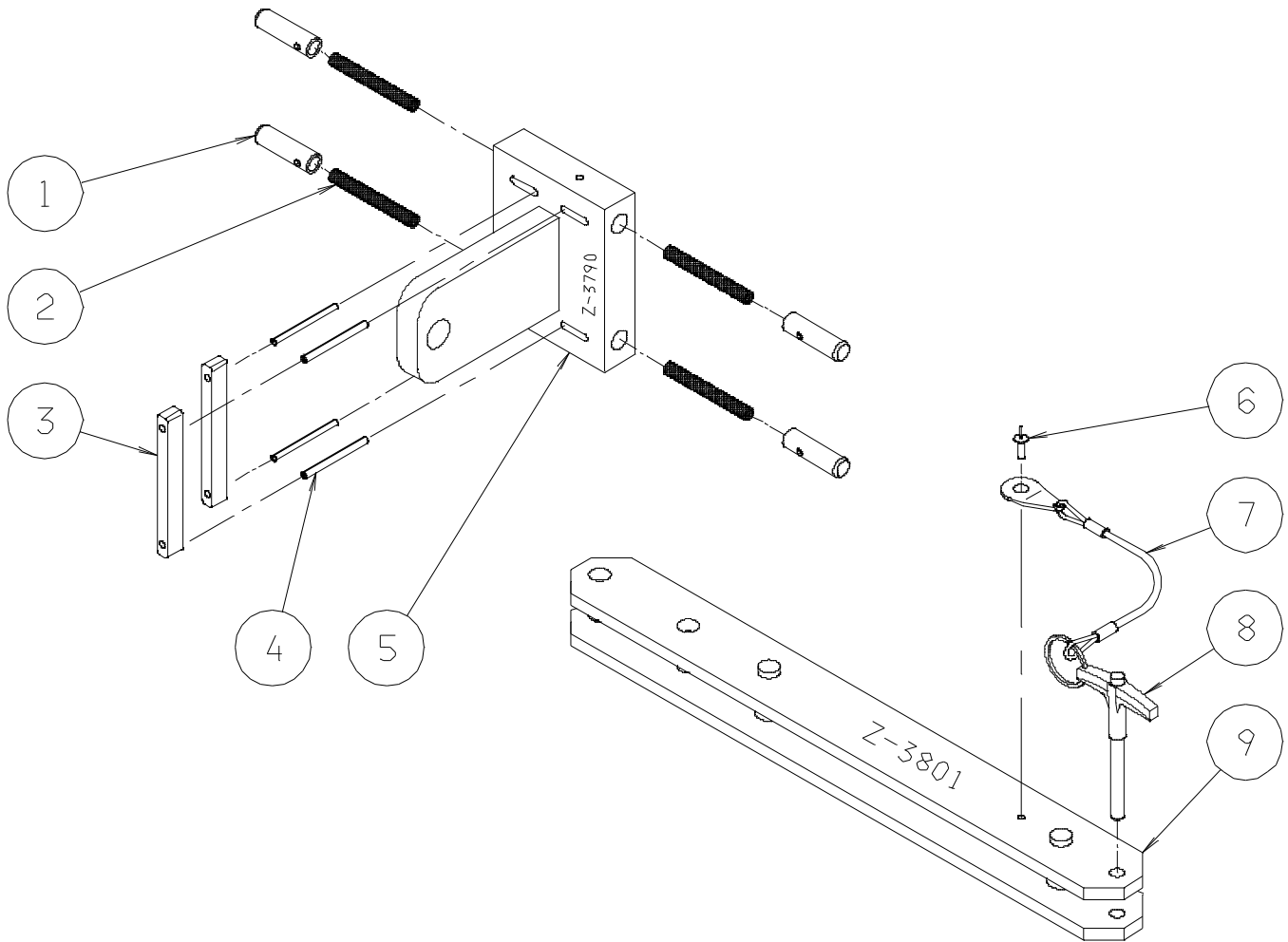

ITEM	PART NO.	DESCRIPTION	QTY
1.....	R-1026 .....	Engagement Pin .....	4
2.....	H-1144 .....	Compression Spring .....	4
3.....	J-2712 .....	Handle .....	2
4.....	G-1300-13120 .....	1/2" x 1 1/4" long Roll Pin .....	4
5.....	Z-3789 .....	TFE-731 Mount Weldment .....	1
6.....	G-1351-04 .....	1/8" Steel Open-End Rivet .....	1
7.....	H-1026*07.0 .....	Lanyard Assembly .....	1
8.....	G-1310-0413 .....	1/4" Diameter x 1.3" long Ball Lok-T Pin .....	1
9.....	Z-3800 .....	TFE-731 Rear Adaptor Weldment .....	1