



**Model: K-2808
TFE-731-20
Engine Adapter Kit**

**Parts List
With Illustration**



05/1998 – Rev. OR

**** When ordering Replacement Parts/Kits, please specify Model, Color and Serial Number of your Unit. ****

Model: K-2808
TFE-731-20 Engine Adapter Kit

This product can not be modified without the written approval of Tronair, Inc. Any modifications done without written approval voids all warranties and releases Tronair, Inc., its suppliers, distributors, employees, or financial institutions from any liability from consequences that may occur. Only Tronair OEM replacement parts shall be used.

This Pratt Whitney TFE-731-20 engine support kit is to be used with the 08-2030-0000 engine stand. The engine stand has multiple adjustments to accommodate the installation of various engines by using specific engine adapter kits.

ENGINE INSTALLATION INSTRUCTIONS:

1. With engine hanging from the 08-0133-4000 engine sling and K-2809 strap kit, remove the existing air frame mounts from the engine.
2. Attach the engine mounting adapters (Z-4052) to the engine mounting locations on the front of the engine and attach the rear mounting adapter (Z-3888) to the rear attach point on the engine. See Figure 1.
3. Position the front support beam $29\frac{3}{4}$ inches from the rear support post. See Figure 1.
4. Position the height of the rear support up $11\frac{1}{8}$ inches. See Figure 1.
5. Position engine into the engine stand and attach rear adapter to engine stand.
6. Adjust final location of the front support beam and attach the front engine mounting pads to the engine stand.
7. Tighten the lockout screws on the front support beam.
8. The engine sling can now be removed for engine service.
9. Reverse steps 2-8 to remove the engine from the stand.

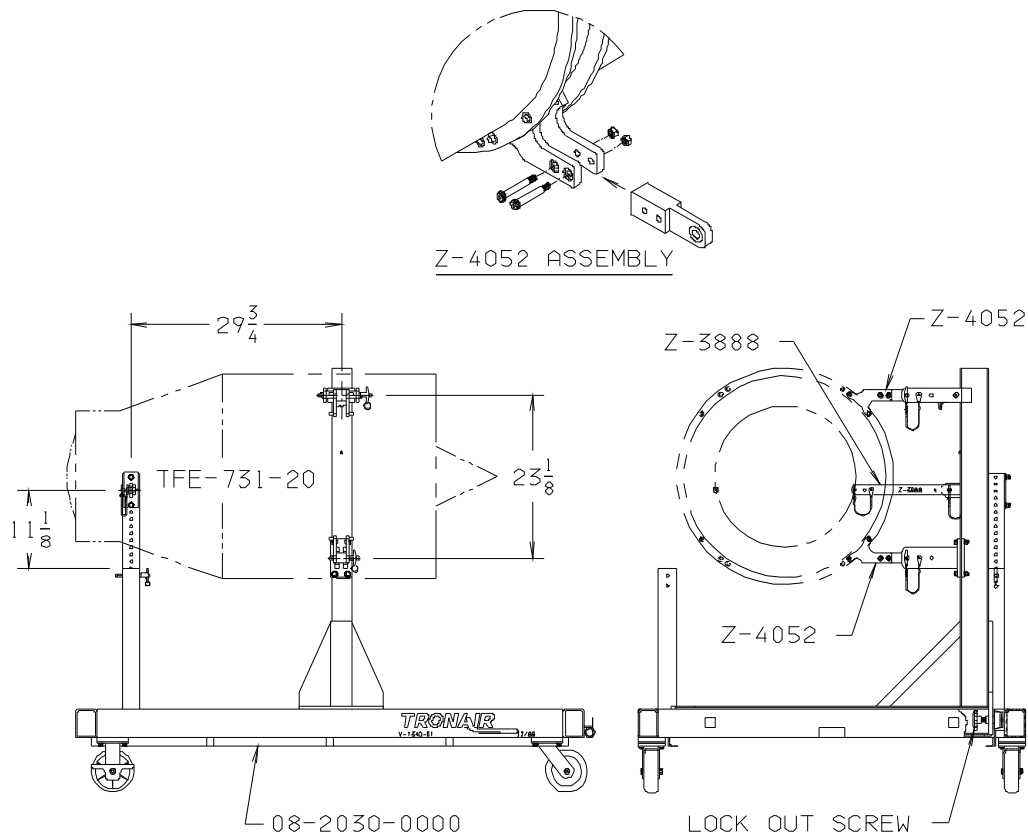
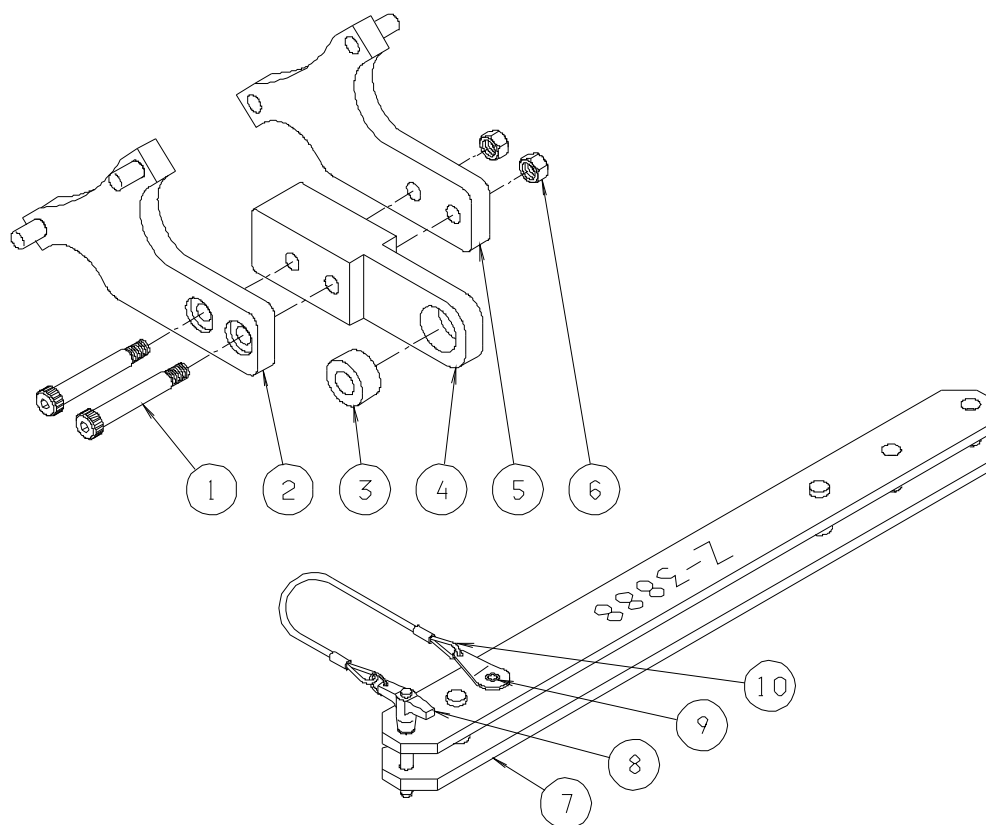

FIGURE 1

Parts List



ITEM	PART NUMBER	DESCRIPTION	QTY
7	Z-3887	Rear Adapter Weldment.....	1
	K-2530	Kit, Replacement Ball Lok-T Pin: consists of:	
8		Ball Lok-T Pin, 1/4" diameter x 1.3" long.....	1
9		1/8" Steel Open End Rivet	1
10		Lanyard Assembly	1
	K-2957	Kit, Replacement Front Adapter: consists of:	
1		3/8" Diameter Socket Head Shoulder Screw	2
2		Left Adapter Plate Assembly	1
3		Headless Bushing	1
4		Front Adapter Connector Plate	1
5		Right Adapter Plate Assembly.....	1
6		Hex Nut, 5/16-18	2



APPENDIX II

Declaration of Conformity



DECLARATION of CONFORMITY

The design, development and manufacture is in accordance with European Community guidelines

K-2808
Engine Adapter Kit
TFE-731-2U

Relevant draft complied with by the machinery:
EN ISO 12100-1

Relevant standards complied with by the machinery:
EN ISO 12100-1
EN 1915-1:2001 (5.20)

Identification of person empowered to sign on behalf of the Manufacturer:

A handwritten signature in black ink that reads "David L. Kidd".

Quality Assurance Representative