



# OPERATION & SERVICE MANUAL

## Model: K-3589 B4 Work Platform Conversion Kit

03/2025 – Rev. 01

**For Spare Parts, Operations & Service Manuals or Service Needs  
Scan the QR code or visit [Tronair.com/aftermarket](https://Tronair.com/aftermarket)**



The Tronair Group of Companies: Tronair | EBIS | Columbus Jack | Eagle | Malabar International

**Tronair, Inc.**  
1 Air Cargo Pkwy East  
Swanton, OH 43558

Phone: (419) 866-6301 | 800-426-6301  
Web: [www.tronair.com](https://www.tronair.com)  
Email: [sales@tronair.com](mailto:sales@tronair.com)

REVISION	DATE	TEXT AFFECTED
OR	11/2021	Original release
01	03/2025	Major revision

This product can not be modified without the written approval of Tronair, Inc. Any modifications done without written approval voids all warranties and releases Tronair, Inc., its suppliers, distributors, employees, or financial institutions from any liability from consequences that may occur.

## 1.0 PRODUCT INFORMATION

### 1.1 DESCRIPTION

This kit is used to convert Tronair 04-6029-5111 and 04-6029-5112 B4 Type Work Platforms to B5 Type Work Platform (Tronair Model 04-6030-5112).

### 1.2 MODEL & SERIAL NUMBER

Reference nameplate on unit

### 1.3 MANUFACTURER

**TRONAIR, Inc.**  
1 Air Cargo Pkwy East  
Swanton, Ohio 43558 USA

Telephone: (419) 866-6301 or 800-426-6301  
Fax: (419) 867-0634  
E-mail: sales@tronair.com  
Website: www.tronair.com

## 1.0 SPECIFICATIONS

Capacity ..... 500 lbs (226.8 kg)  
Work Platform Area ..... 3 ft x 8 ft (.91 m x 2.44 m)  
Lowered Platform Height ..... 8.5 ft (2.59 m)  
Raised Platform Height ..... 12 ft (3.66 m)

- Mechanical Platform Stops
- Removable Side Rails
- Hydraulic Foot Pedal
- Locking Swivel Casters
- Towbar
- Optional Pneumatic Foot Pedal

## 2.0 SAFETY INFORMATION

### 2.1 USAGE AND SAFETY INFORMATION

To ensure safe operations please read the following statements and understand their meaning. Also refer to your equipment manufacturer's manual for other important safety information. This manual contains safety precautions which are explained below. Please read carefully.



#### WARNING!

Warning is used to indicate the presence of a hazard that can cause **severe personal injury, death, and/or substantial property damage** if the Warning Notice is ignored.



#### CAUTION!

Caution is used to indicate the presence of a hazard, which will or can cause **minor personal injury or property damage** if the Caution Notice is ignored.

## 3.0 TRAINING

### 3.1 TRAINING REQUIREMENTS

The employer of the operator is responsible for providing a training program sufficient for the safe operation of the unit.

### 3.2 TRAINING PROGRAM

The employer provided operator training program should cover safety procedures concerning use of the unit in and around the intended aircraft at the intended aircraft servicing location.

### 3.3 OPERATOR TRAINING

The operator training should provide the required training for safe operation of the unit.

**NOTE: Maintenance and Trouble Shooting are to be performed by a skilled and trained technician.**

## 4.0 B4 DISASSEMBLY INSTRUCTION

1. Raise platform three to four feet (3-4 ft) so as to work comfortably on outside of platform frame. Secure platform position using the safety stop pins. (See **Figure 1**)
2. Installation of corner bumpers: Using a #9 (0.196 inch diameter) drill bit, drill pilot holes through bumpers and frame base. Use two (2) rivets per leg of bumper on the top and one (1) rivet per leg on the bottom. For modified bumpers (around the ladder), use only one (1) rivet on the top and bottom of the shortened leg.
3. Lower platform.
4. Remove towbar via 3/8 inch shoulder bolts. Retain towbar and fasteners for re-use.
5. Securely lift platform so that casters are approximately 68 inches of the ground.



### WARNING!

**Never work directly under a suspended load.**

6. Remove casters and swivel locks. Take notice of orientation of swivel locks for installation on B5 extension the same way.

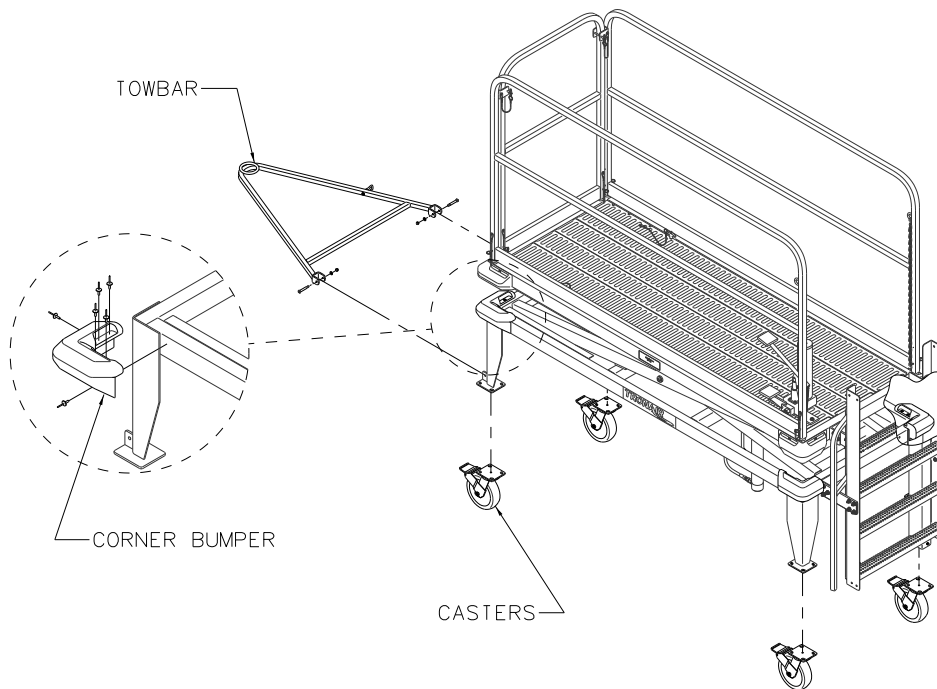

**FIGURE 1**

## 5.0 ASSEMBLY INSTRUCTIONS

1. Install platform extensions to the bottom of platform assembly using 3/8-16 x 1-1/2 inch long bolts (See **Figure 2**).

**NOTE: Do not tighten bolts.**

2. Install extension braces, casters and swivel locks using 3/8-16 x 1-1/2 inch long bolts. (See **Figure 3**) Make note of position of towbar mounts on lower front brace.

**NOTE: Do not tighten bolts.**

3. Install cross braces using 3/8-16 x 3 inch long bolts (See **Figure 4**).
4. Tighten all bolts; torque to 25 in-lbs.
5. Install the ladder extension using the splice plates and 3/8-16 x 1-1/2 inch long bolts. Assemble the extension handle using 3/8-16 x 1-1/2 inch long bolts and secure the ladder to the extension brace using the U-bolt, angle and 3/8-16 x 1-1/2-inch long bolts. (See **Figure 5**).
6. Install the towbar on frame extension using existing 3/8 inch diameter shoulder bolts (See **Figure 6**).

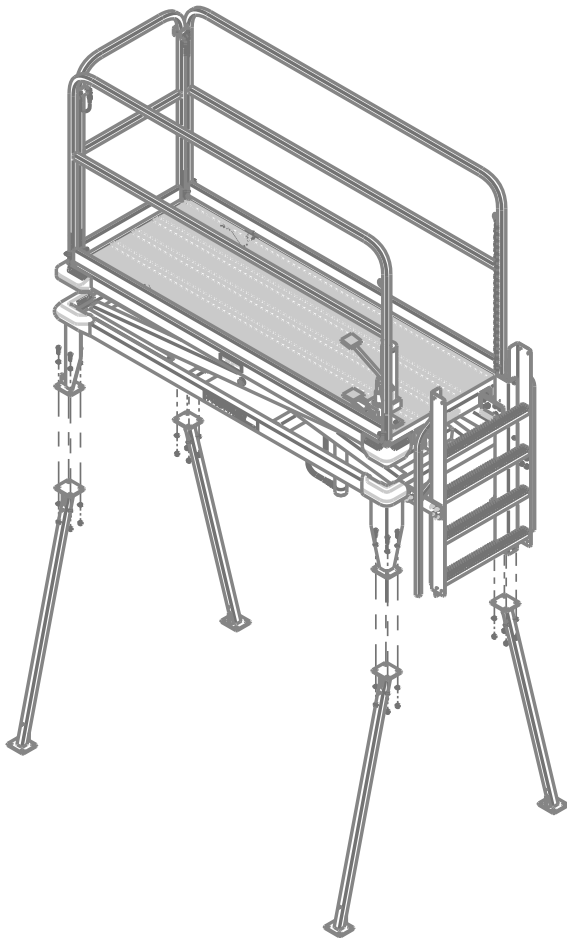

FIGURE 2

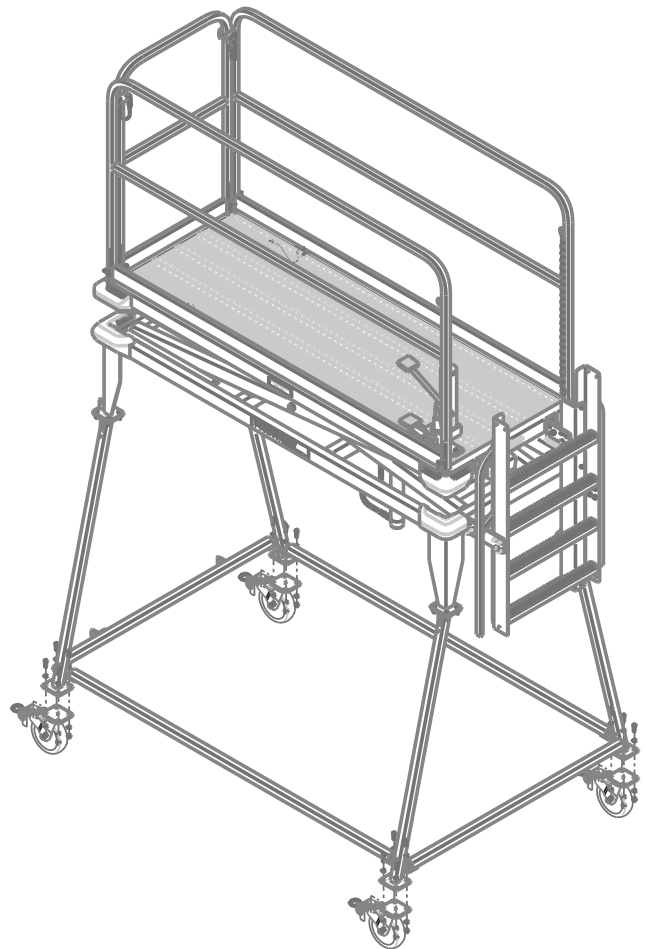
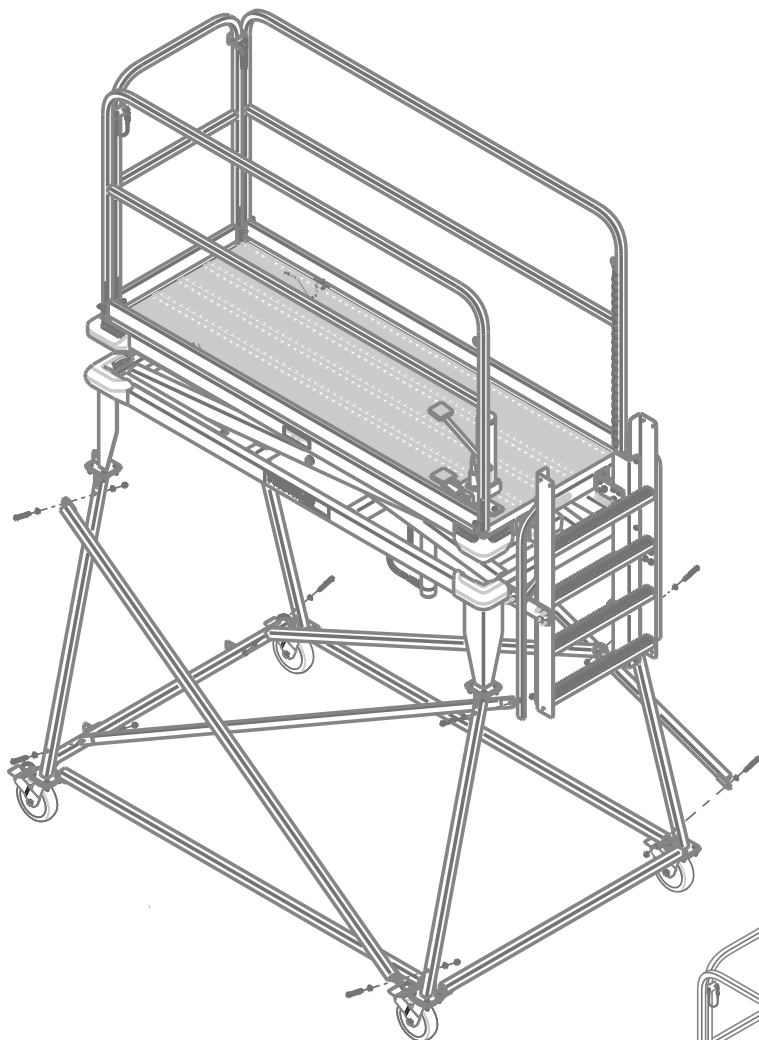
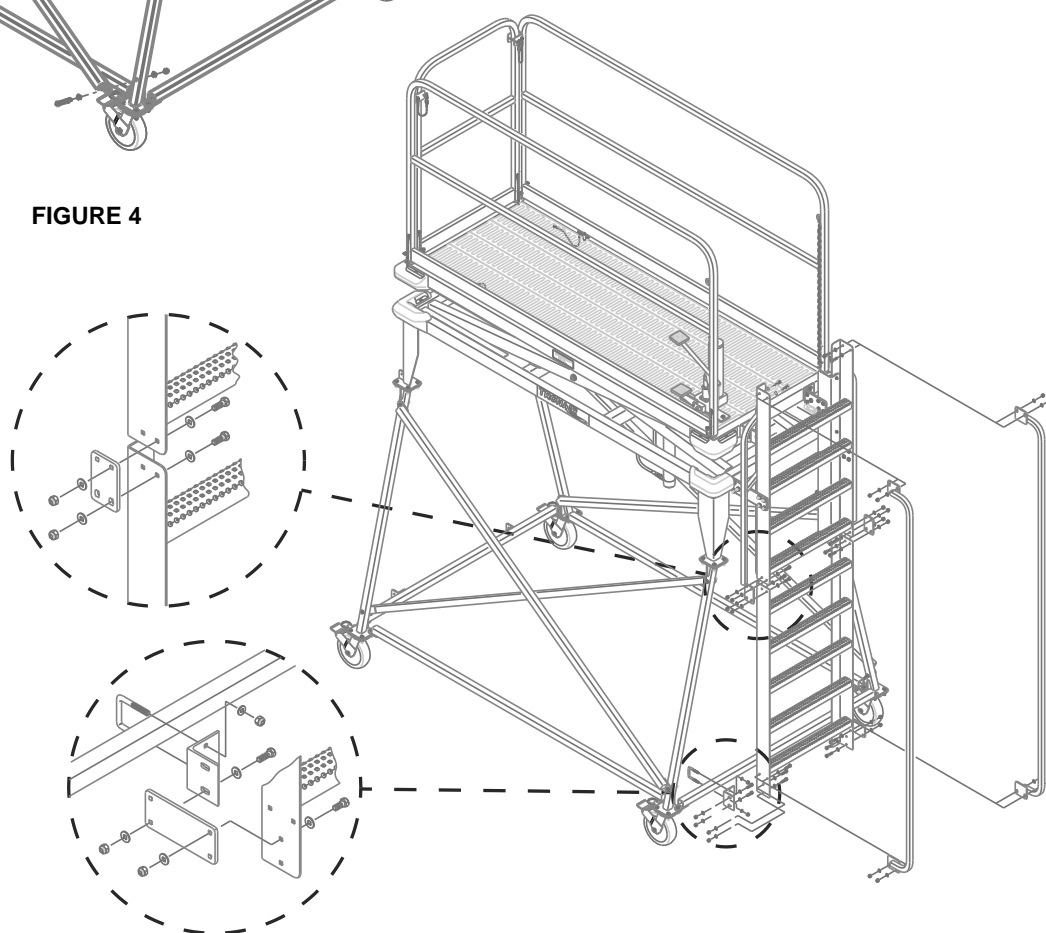

FIGURE 3



**FIGURE 4**

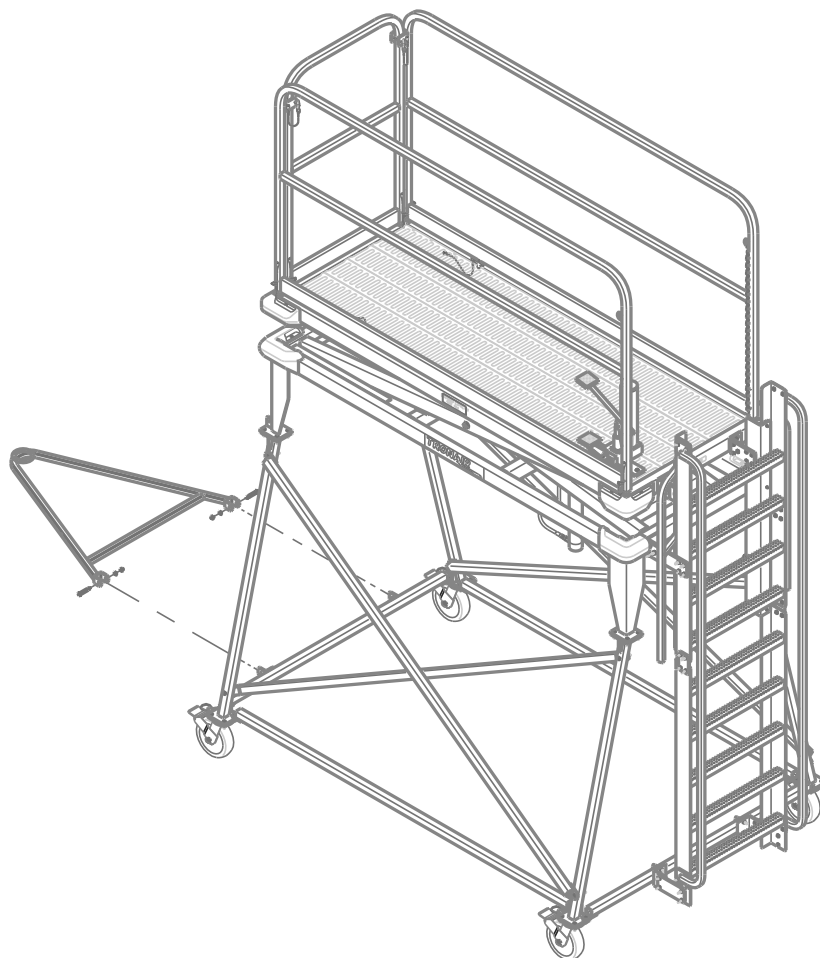

**FIGURE 5**

**FIGURE 6**

**6.0 PROVISION OF SPARES****6.1 SOURCE OF SPARE PARTS**

Spare parts may be obtained from the manufacturer:

**TRONAIR**, Inc.

1 Air Cargo Pkwy East

Swanton, Ohio 43558 USA

Telephone: (419) 866-6301 or 800-426-6301

Fax: (419) 867-0634

E-mail: [sales@tronair.com](mailto:sales@tronair.com)

Website: [www.tronair.com](http://www.tronair.com)



For Spare Parts, Operations & Service Manuals or Service Needs:  
Scan the QR code or visit [Tronair.com/aftermarket](http://Tronair.com/aftermarket)

**7.0 GUARANTEES/LIMITATION OF LIABILITY**

Tronair products are warranted to be free of manufacturing or material defects for a period of one year after shipment to the original customer. This is solely limited to the repair or replacement of defective components. This warranty does not cover the following items:

- a) Parts required for normal maintenance
- b) Parts covered by a component manufacturers warranty
- c) Replacement parts have a 90-day warranty from date of shipment

If you have a problem that may require service, contact Tronair immediately. Do not attempt to repair or disassemble a product without first contacting Tronair, any action may affect warranty coverage. When you contact Tronair be prepared to provide the following information:

- a) Product Model Number
- b) Product Serial Number
- c) Description of the problem

If warranty coverage is approved, either replacement parts will be sent or the product will have to be returned to Tronair for repairs. If the product is to be returned, a Return Material Authorization (RMA) number will be issued for reference purposes on any shipping documents. Failure to obtain a RMA in advance of returning an item will result in a service fee. A decision on the extent of warranty coverage on returned products is reserved pending inspection at Tronair. Any shipments to Tronair must be shipped freight prepaid. Freight costs on shipments to customers will be paid by Tronair on any warranty claims only. Any unauthorized modification of the Tronair products or use of the Tronair products in violation of cautions and warnings in any manual (including updates) or safety bulletins published or delivered by Tronair will immediately void any warranty, express or implied.

The obligations of Tronair expressly stated herein are in lieu of all other warranties or conditions expressed or implied. **Any unauthorized modification of the Tronair products or use of the Tronair products in violations of cautions and warnings in any manual (including updates) or safety bulletins published or delivered by Tronair will immediately void any warranty, express or implied and Tronair disclaims any and all liability for injury (WITHOUT LIMITATION and including DEATH), loss or damage arising from or relating to such misuse.**



## Parts List

When ordering replacement parts/kits, please specify model, serial number and color of your unit.

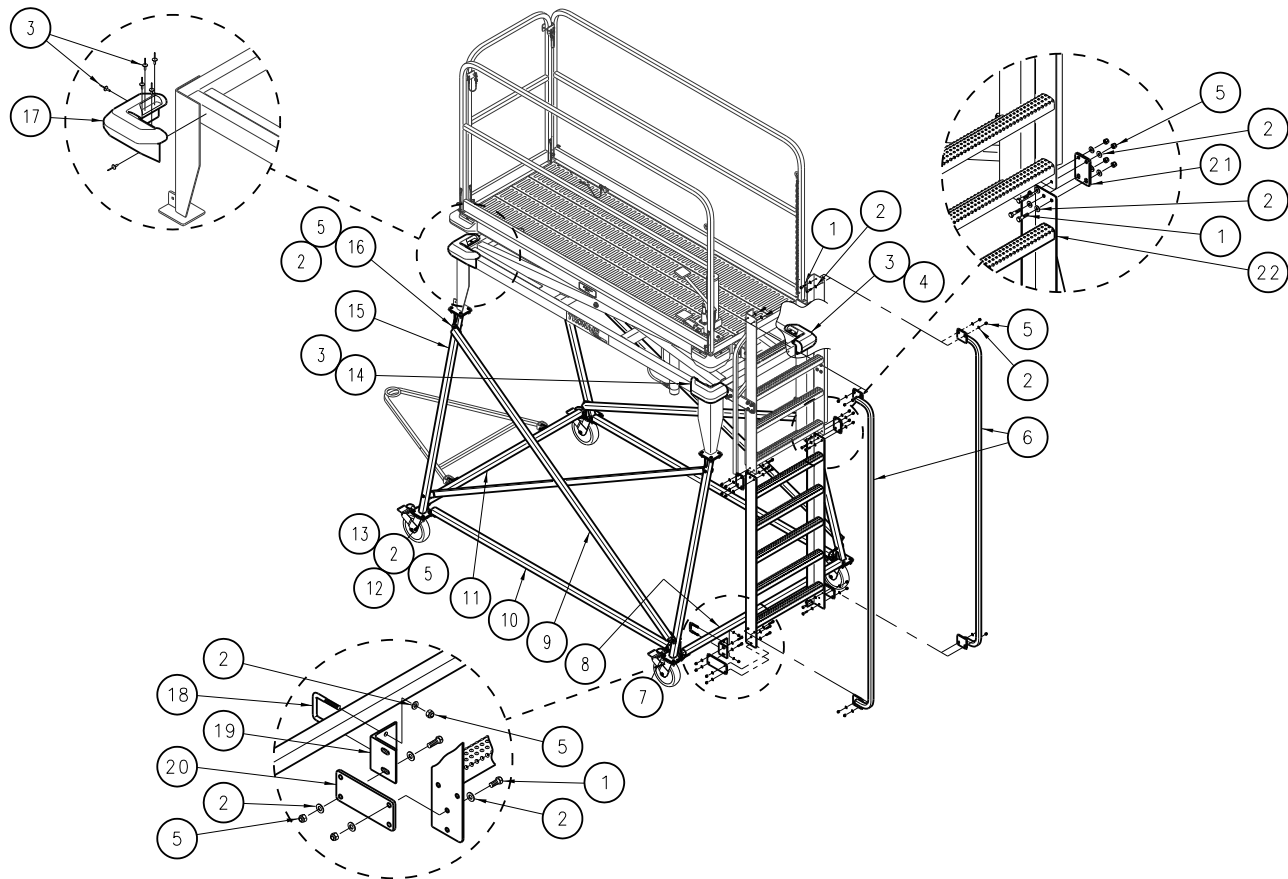

Item	Part Number	Description	Qty
1	G-1100-107012	BOLT, HEX HEAD, GRADE 5, 3/8-16 X 1-1/4" LONG	20
2	G-1250-1070N	FLATWASHER, 3/8 NARROW	128
3	G-1352-29	RIVET, 3/16 OPEN-END ALUMINUM	24
4	H-2501-01	BUMPER, CORNER (MODIFIED)	1
5	G-1202-1070	STOPNUT, 3/8-16 ELASTIC	68
6	Z-4567-01	WELDMENT, B5 LADDER HANDLE	2
7	H-2338	CAP, END (FOR 1-1/2" TUBE)	16
8	Z-4581-01	WELDMENT, B5 LEG BRACE	1
9	Z-4678-01	WELDMENT, B5 CROSS BRACE	4
10	Z-4580-01	WELDMENT, B5 LEG BRACE	2
11	Z-4582-01	WELDMENT, B5 LEG BRACE	1
12	G-1100-107016	BOLT, HEX HEAD, GRADE 5, 3/8-16 X 1-3/4" LONG	4
13	G-1100-107014	BOLT, HEX HEAD, GRADE 5, 3/8-16 X 1-1/2" LONG	32
14	H-2501-02	BUMPER, CORNER (MODIFIED)	1
15	Z-4579-01	WELDMENT, B5 LEG EXTENSION	4
16	G-1100-107024	BOLT, HEX HEAD, GRADE 5, 3/8-16 X 2-1/2" LONG	8
17	H-2498	BUMPER, CORNER	2
18	G-1370-01	U-BOLT, SQUARE BEND	2
19	A-1163-01	ANGLE, EXTENSION MOUNT	2
20	J-3061-01	PLATE, LADDER MOUNT	2
21	J-3056-01	PLATE, LADDER MOUNT	2
N/S	H-1143	CAP, END(FOR 1" TUBE)	4