

K-4301 - Pneumatic Pump Kit

This product can not be modified without the written approval of Tronair, Inc. Any modifications done without written approval voids all warranties and releases Tronair, Inc., its suppliers, distributors, employees, or financial institutions from any liability from consequences that may occur. Only Tronair OEM replacement parts shall be used.

1.0 GENERAL DESCRIPTION

The Tronair Model Lavatory Service Unit (LSU) provides a clean, sanitary means of servicing the aircraft lavatory system and transporting the waste fluid to the dump station.

Some important features are:

- Easily maneuverable with towbar
- Brakes on front tires for locking in static position
- Drain back system on fill hose to prevent fluid spillage
- Storage provided for fill and dump hoses and connector
- Heavy duty fill pump
- Fill and dump tanks made of non-corroding HD polyethylene material with UV inhibitor
- 3 inch I.D. gravity drain valve in dump tank with removable hose and fitting

2.0 TECHNICAL SPECIFICATIONS

Dimensions: 64 inches Long x 37-1/2 inches Wide x 49-1/2 inches High (with towbar in up position.)

Weight: 600 pounds

2.1 FILL (FRESH) SYSTEM

- 31 gallon tank capacity; HD polyethylene
- 0-14 gpm pneumatic pump
- 0-100 psi operating pressure, 125 psi max
- Three (3) inch tank fill port with cover
- Eight (8) foot fill hose

2.2 DUMP SYSTEM

- 68 gallon tank capacity; HD polyethylene
- Six (6) inch tank clean out port with cover
- Four (4) inch aluminum tank flange for aircraft dump hose connection
- 18 inch long, three (3) inch I.D. dump tank hose with 45 connector

2.3 MECHANICAL

- Pneumatic tires front (steering) wheels with semi-sealed ball bearing (Tire size 410/350 x 4) 50 psi tire pressure maximum
- Pneumatic tired rear wheels with tapered roller bearings (Tire size 4.80/4.00 x 8) 50 psi tire pressure maximum
- Towing speed - 10 mph maximum

2.4 KITS

The following kits are available for Model: 10-6410-0000 LSU:

- K-2410 Kit, Fill Connector
- K-2412 Kit, Dump Connector with 5 foot hose
- K-2029 Kit, Dump Connector
- K-2030 Kit, Dump Connector; mates with K-2412
- K-3606 Kit, Hose Cap (Dump Hose)

3.0 INSTALLATION

1. Remove old fill pump and mounting plate from unit.
2. Attach new plate reusing existing hardware.
3. Install pneumatic pump to plate using 1/4 " washers, 1/4 - 20 bolts and nuts.
4. Install elbow and quick disconnect to regulator.
5. Install 3/4 ID hoses to pump using hose clamps and 1/2 NPT x 3/4 hose barbs provided.
6. Install regulator assembly to pump assembly.
7. Attach air to quick disconnect on regulator and adjust as necessary.

4.0 GUARANTEES/LIMITATION OF LIABILITY

Tronair products are warranted to be free of manufacturing or material defects for a period of one year after shipment to the original customer. This is solely limited to the repair or replacement of defective components. This warranty does not cover the following items:

- a) Parts required for normal maintenance
- b) Parts covered by a component manufacturers warranty
- c) Replacement parts have a 90-day warranty from date of shipment

If you have a problem that may require service, contact Tronair immediately. Do not attempt to repair or disassemble a product without first contacting Tronair, any action may affect warranty coverage. When you contact Tronair be prepared to provide the following information:

- a) Product Model Number
- b) Product Serial Number
- c) Description of the problem

If warranty coverage is approved, either replacement parts will be sent or the product will have to be returned to Tronair for repairs. If the product is to be returned, a Return Material Authorization (RMA) number will be issued for reference purposes on any shipping documents. Failure to obtain a RMA in advance of returning an item will result in a service fee. A decision on the extent of warranty coverage on returned products is reserved pending inspection at Tronair. Any shipments to Tronair must be shipped freight prepaid. Freight costs on shipments to customers will be paid by Tronair on any warranty claims only. Any unauthorized modification of the Tronair products or use of the Tronair products in violation of cautions and warnings in any manual (including updates) or safety bulletins published or delivered by Tronair will immediately void any warranty, express or implied.

The obligations of Tronair expressly stated herein are in lieu of all other warranties or conditions expressed or implied. **Any unauthorized modification of the Tronair products or use of the Tronair products in violations of cautions and warnings in any manual (including updates) or safety bulletins published or delivered by Tronair will immediately void any warranty, express or implied and Tronair disclaims any and all liability for injury (WITHOUT LIMITATION and including DEATH), loss or damage arising from or relating to such misuse.**

Parts List

When ordering Replacement Parts/Kits, please specify Model, Color and Serial Number of your Unit

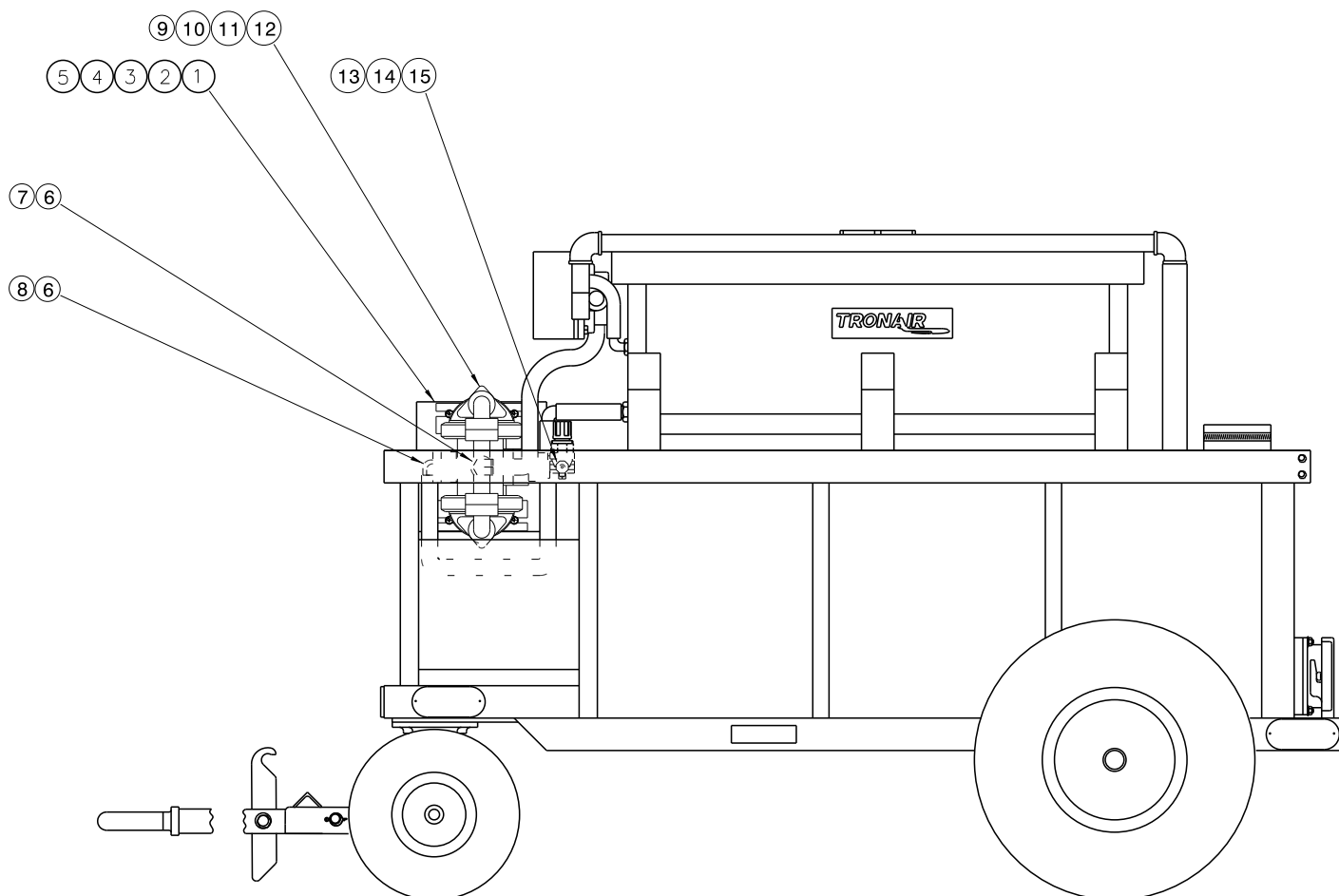

Item	Part Number	Description	Qty
1	J-4362-01	Plate, Pump	1
2	G-1100-107520	Bolt, HH GR 5, 3/8 – 24 x 2 Long	4
3	G-1202-1075	ESN, 3/8 – 24	4
4	G-1250-1070N	Flatwasher, 3/8 Narrow	8
5	H-1516-17	Clamp, 1 – ¼ Nominal, 2 ear hose	2
6	N-1040-09	Elbow, ½ NPT x ¾ Hose	2
7	TF-1009-03*26.0	Hose, ¾ ID	1
8	TF-1009-03*20.0	Hose, ¾ ID	1
9	G-1250-1050N	Flatwasher, ¼ Narrow	12
10	G-1100-105010	Bolt, HH ¼ - 20 x 1 Long	4
11	G-1202-1050	ESN, ¼ -20	4
12	H-2660	Pump, Pneumatic (MB)	1
13	N-2201-04-S	Elbow, Male Pipe, ¼ x ¼	1
14	H-1397	Regulator	1
15	H-2016-11	Disconnect, Quick	1

Parts List

When ordering Replacement Parts/Kits, please specify Model, Color and Serial Number of your Unit

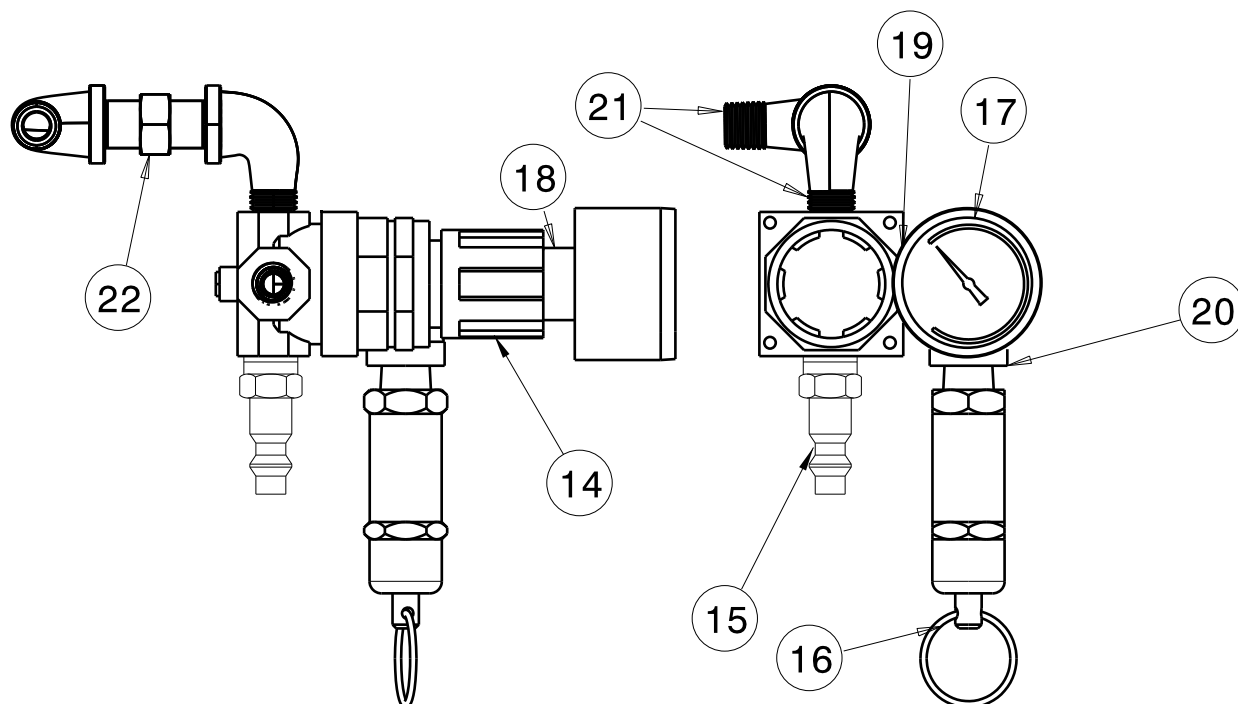

Item	Part Number	Description	Qty
14	H-1397	Regulator	1
16	PC-1017-02-125	Valve, Safety	1
17	HC-1831	Gauge, Pressure, 0-160 psi	1
18	N-2210-02-S	Reducer, Pipe Thread	1
19	N-2201-03-S	Elbow, Male Pipe	1
20	N-2207-04-S	Tee, Female Pipe	1
21	N-2201-03-S	Elbow, Male Pipe	2
22	N-2203-04-S	Nipple, Pipe	1